

- NOTES:-
- ALL DIM. ARE IN MILIMETER UNLESS NOTED OTHERWISE
 - NOT MORE THEN HALF THE COLUMN BARS SHALL BE LAPED AT A SECTION
 - GRADE OF CONCRETE MIX SHALL BE M-30 CONFIRMING TO IS:456 - 2000.
 - STEEL REINFORCEMENT SHALL BE GRADE Fe:500-D N/SQ. mm AS PER IS:1786-2007.
 - CLEAR COVER TO THE R/F SHALL BE AS FOLLOWS.
 - I COLUMN - 40mm ALROUND
 - II FOOTING - 60 mm
 - III BEAM - 25 mm ALROUND
 - IV SLAB - 20 mm TOP/BOT.
 - DEVELOPMENT LENGTH & LAP LENGHT SHALL BE 50 TIMES DIA OF BAR
 - TOP & BOTTAM BARS SHOULD BE BEND AT THE ENDS AT LEAST FOR BEAM DEPTH IN CASE OF DEVELOPMENT LENGTH SATISFIED.
 - TOP BARS OF BEAM SHALL BE LAPPED AT THE CENTRE OF THE SPAN AND BOTTAM BARS SHALL BE LAPPED AT TWICE THE DEPTH AWAY FROM SUPPORT OR AT SUPPORT WITH LAP LENGHT FOR BOTH THE BARS
 - COLUMN FOOTING HAS BEEN DESIGN FOR GROUND FLOOR, FIRST AND SECOND
 - THE COLUMN BARS SHALL BE LAPPED AT THE MIDDLE OF THE STOREY HEIGHT AND STAGGED BY 1.3 TIMES DEVELOPMENT LENGHT-Ld
 - THE SAFE BEARING CAPACITY OF SOIL IS 500 KN/ SQ. M.
 - AS FAR AS POSSIBLE THE BOTTOM LEVEL OF FOOTING SHOULD BE SAME OTHERWISE WELL WITHIN THE DISPERSION ANGLE OF LOAD TO ADJACENT FOOTING TO AVOID OVER STRESSING OF SOIL OF LOWER LEVEL FOOTING WHICH IS LIKELY TO COME IN LOAD DISPERSION RANGE.
 - THE STRUCTURE HAS BEEN DESIGNED AS PER IS:1893 WITH AN IMPORTANCE FACTOR-1.50.
 - THE DETAILING OF REINFORCEMENT SHAL BE DONE AS PER IS:13920 & REFER DET. DRG. WHICH WILL PROVIDE SEPARTELY.
 - ALL THE FLOOR IMPOSED LOADING HAS BEEN TAKEN AS PER IS:875 PART-2.

CONCRETE MIX DESIGN OF GRADE M30
 ORDINARY PORTLAND CEMENT-50 Kg.
 FINE AGGREGATE (SAND)-84 Kg
 COARCE AGGREGATE - 150 Kg
 AGGREGATE 12 MM & DOWN - 60 Kg. &
 AGGREGATE 20 MM & DOWN - 90 Kg.
 POTABLE WATER - 22.50 LITRES/BAG

CONCRETE MIX DESIGN PER CUM. OF GRADE M30
 ORDINARY PORTLAND CEMENT-400 Kg.
 FINE AGGREGATE (SAND)-640 Kg
 COARCE AGGREGATE - 1200 Kg
 AGGREGATE 12 MM & DOWN - 560 Kg.
 AGGREGATE 20 MM & DOWN - 640 Kg.
 WATER CEMENT RATIO - 0.45
 POTABLE WATER - 180 LITRES/BAG

SCHEDULE OF COLUMN REINFORCEMENT

C.NO.	SIZE	MAIN BAR	SPACING OF RINGS	CONC. MIX.	REMARK
C1	300X600	8 NOS.-20#	2 NOS.- 8# @ 150c/c	M-30	
C2	300X600	4 NOS.-20# + 4 NOS.-16#	2 NOS.- 8# @ 150c/c	M-30	
C3	300X600	8 NOS.-25#	2 NOS.- 8# @ 150c/c	M-30	
C3A	400X600	4 NOS.-25# + 4 NOS.-20#	2 NOS.- 8# @ 150c/c	M-30	
C4	400X600	10 NOS.-25#	2 NOS.- 8# @ 150c/c	M-30	
C5	300X600	10 NOS.-25#	2 NOS.- 8# @ 150c/c	M-30	

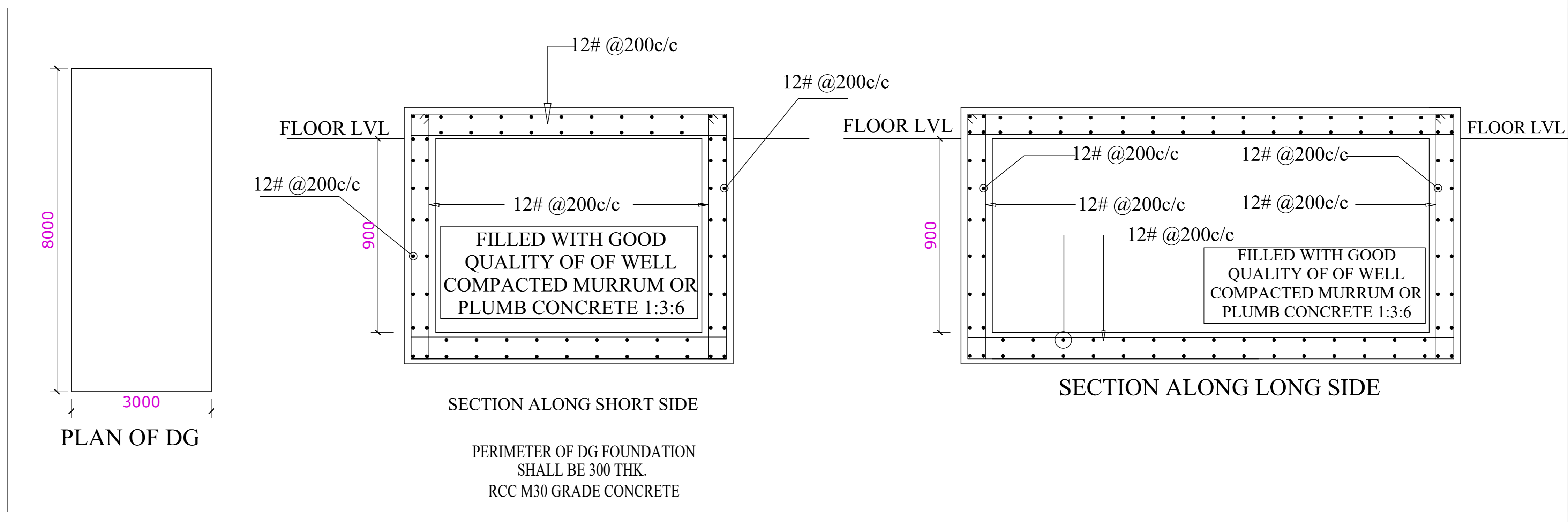

SCHEDULE OF FOOTING REINFORCEMENT WITH STEPS

F.NO.	FOOT. SIZE	TOTAL DEPTH	FOOTING STEP-1			FOOTING STEP-2			FOOTING STEP-3			FOOTING STEP-4			STEEL ALONG SHORT SIDE	STEEL ALONG LONG SIDE	CONC. MIX.	REMARK
			W1	L1	D1	W2	L2	D2	W3	L3	D3	W4	L4	D4				
F1	2100X2400	800	2100	2400	300	1600	1900	250	1000	1300	250	-	-	-	12# @125c/c	12# @125c/c	M-30	
F2	AS SHOWN	800	-	-	-	-	-	-	-	-	-	-	-	-	12# BAR @150 c/c BOTHWAY TOP & BOT	12# BAR @150 c/c BOTHWAY TOP & BOT	M-30	
F3	2300X2600	800	2300	2600	300	1600	1900	250	900	1200	250	-	-	-	12# @125c/c	12# @125c/c	M-30	
F4	2800X3000	1100	2800	3000	300	2200	2400	300	1600	1800	250	1000	1200	250	12# @100c/c	12# @100c/c	M-30	
F5	2400X2700	800	2400	2700	300	1800	2100	250	1100	1400	250	-	-	-	12# @125c/c	12# @125c/c	M-30	

ISSUED TO	DATE	NO. OF PRINTS
REV	DATE	DISCRPTION
Space Forum Architects Pvt. Ltd.		
114, Arniya Plaza 27/2 Manoramaganj Indore - 452001 Phone: (0731) 2494930, 2494284 e-mail: space4rum@yahoo.co.in		
JOB TITLE		
PROPOSED MORTUARY AND ELECRICAL SUB STATION BUILDING FOR MAHATMA GANDHI MISSION TRUST AT MUMBAI.		
SHEET TITLE		
STRUCTURAL DETAILS OF COLUMN- FOOTING.		
DEALT BY.		DRG.NO
CHECKED BY.		S - 01
DATE	05.02.2024	
SCALE		